

Conceptual Site Phasing Diagram Phase 2 - Replacement School Project July 2022 - December 2022

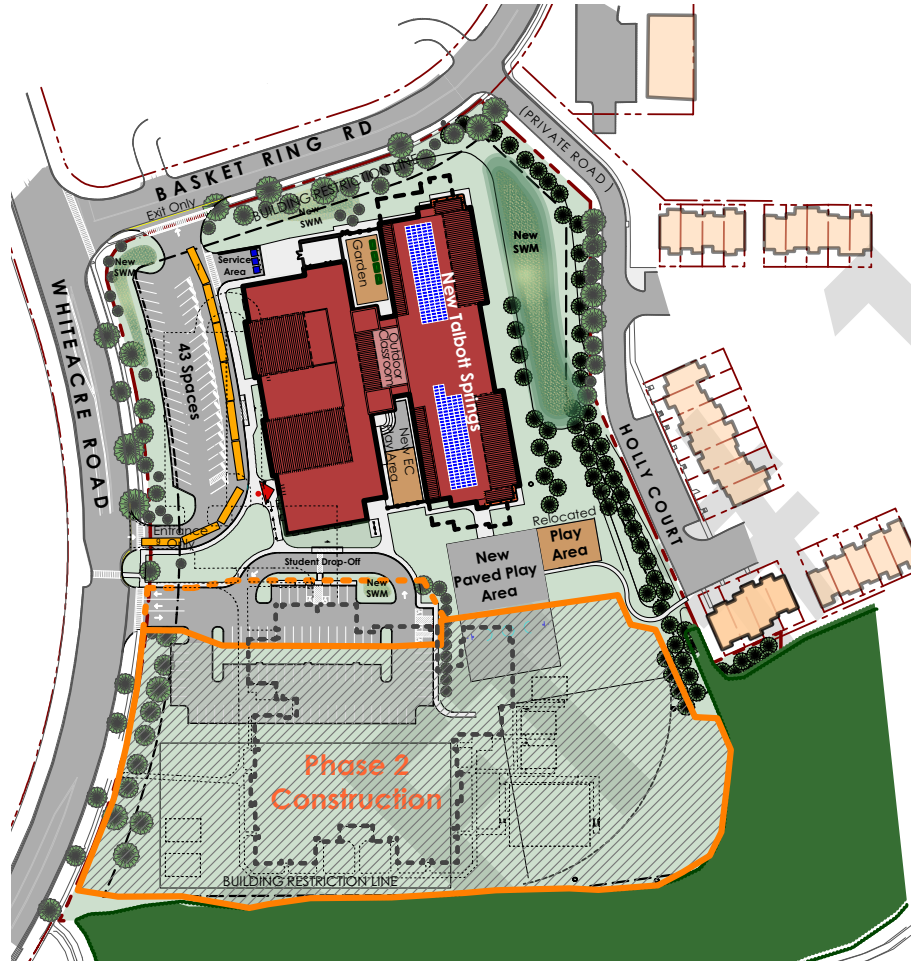

PHASE 2

Existing Building Demolition Phase:

The existing kitchen and adjacent kindergarten classroom area will need to be demolished first to allow for the construction of the new student drop-off area before the school opens in 2022. In addition, the existing play area will need to be relocated to its proposed location before school opens.

During this phase of the project, the new school building will be occupied while the existing building is demolished, including removal of the existing portable classrooms and utilities. The school will have a limited amount of paved play area during this phase, but the relocated play area as well as the completed early childhood play areas will be available for use.

New Parking Lot and Playfields:

Once the existing building is demolished, a new parking lot, multi-purpose field and softball field will be constructed. The large paved play area will be expanded to its final size and game lines will be added. The bus loop and parking area will be re-striped for the final bus and car parking spaces.